

See installation video:

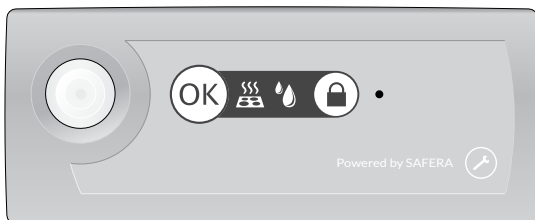

PCU6.3-F



PCU6.1-F



PCU6.1-P



PCU6.3-P



PCU6.1-S

# Installation manual

Safera Siro IN-Line Stove Guard



We sense what humans don't

# Contents

1. Preparations
2. Installation
3. Installation troubleshooting
4. Installing the Water Leakage Sensor (optional)

Follow these instructions carefully and pay particular attention to the instructions marked in the following way:

## **WARNING**

Follow instructions marked with a warning accurately to prevent injury to persons and damage to property.

## **ATTENTION**

Follow instructions marked with a note carefully to prevent damage to property.

## **HINT**

Hints give you useful advice on using the appliance.

# Warnings

## **WARNING**

Read user and installation manual before using or installing the appliance.

Install and check the application according to the instructions. Safera is not liable for any damage or expenses caused by inappropriate installation.

Check that the Stove Guard is compatible with the cooker (see section 1.1).

If the connection cord is damaged, it must be replaced by the service personnel of the manufacturer or their representative to avoid hazards.

All electrical connections must be carried out by a qualified electrician.

## **ATTENTION**

If the appliance was stored in a cold space, it must be allowed to warm up to room temperature before connecting it to mains power.

# 1. Preparations

Check the product and the contents of the package before installation:

- Central Unit **A** (pre-installed into a cooker hood)
- Power Supply **D**
- Power Control Unit **C**
- User and Installation Guides

## **▲ WARNING**

Please contact your vendor if you notice anything unusual about the appliance.

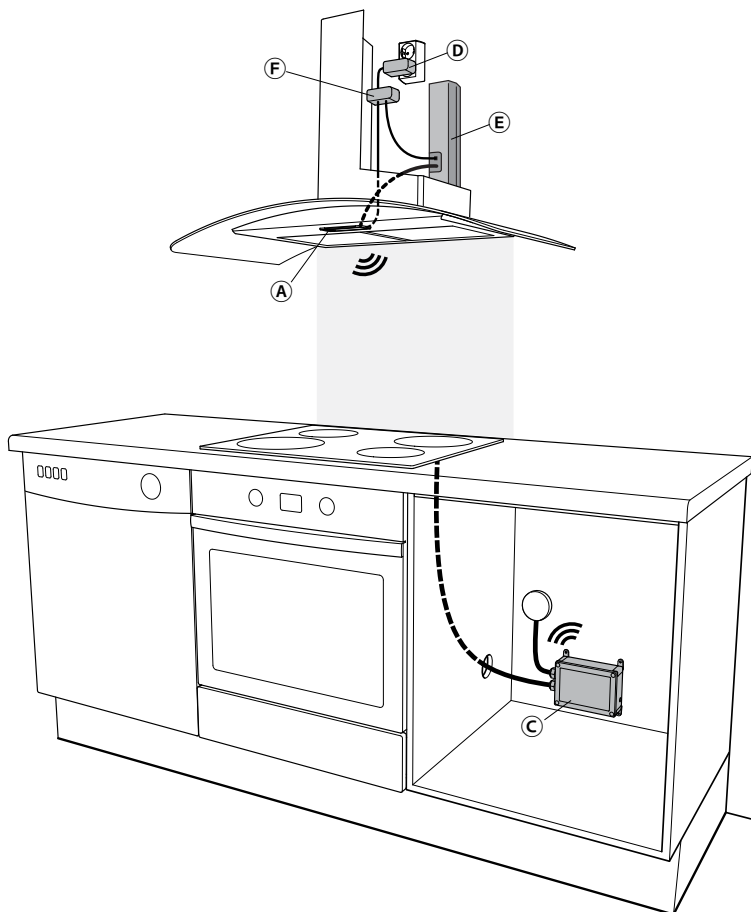

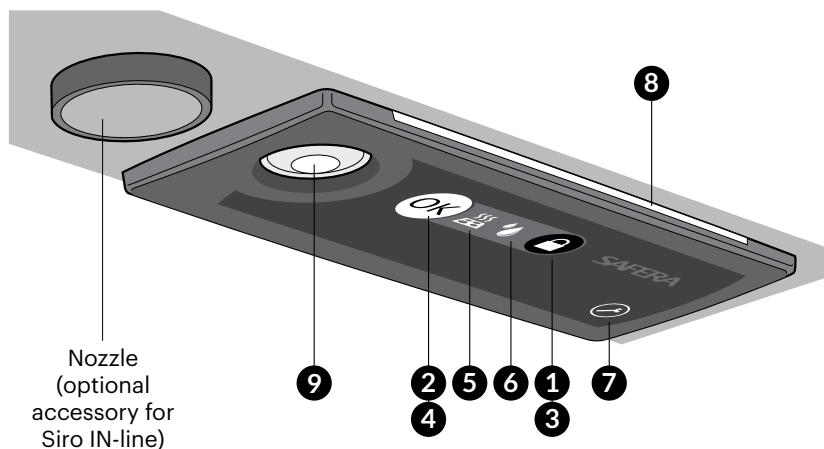

## 1.1 Compatibility

Safera Stove Guard is compatible with most electrical cookers, hobs and ovens meant for household use:

- Traditional cast-iron cookers and hobs
- Ceramic cookers and hobs
- Induction cookers and hobs
- Cookers and hobs equipped with a timer, afterheat indicator, child proof lock or integrated switch-off system

Safera Siro is compatible with cookers no wider than 90 cm, see Installation step 1/6.

## 1.2 Central Unit <sup>Ⓐ</sup>

- 1 Child proof lock button
- 2 OK button
- 3 Indicator light for child proof lock
- 4 Indicator light for normal activity
- 5 Warning light for cooktop hazard
- 6 Warning light for water leakage
- 7 Adjustment mode button
- 8 Indicator light panels
- 9 Sensor

## 2. Installation - Step 1/6

Mount the Central Unit ①

Install the cooker hood with Central Unit ① according to the dimensions:

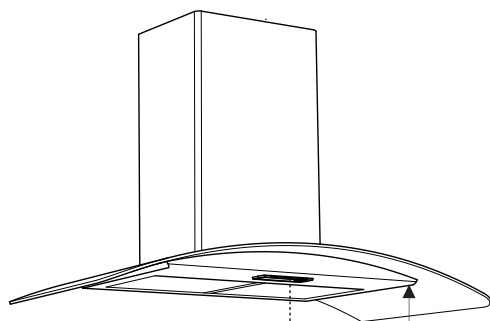

### Width

Align the Central Unit  $\pm 15$  mm with the centre of the cooktop.

### With extinguisher:

| Cooker width | Inst. height |
|--------------|--------------|
|--------------|--------------|

|            |            |
|------------|------------|
| Max. 60 cm | 45 - 55 cm |
|------------|------------|

### Without extinguisher:

| Cooker width | Inst. height |
|--------------|--------------|
|--------------|--------------|

|            |            |
|------------|------------|
| Max. 60 cm | 45 - 75 cm |
|------------|------------|

|            |            |
|------------|------------|
| 60 - 90 cm | 60 - 75 cm |
|------------|------------|

### Depth

Align the Central Unit with the centre of the cooktop:

With extinguisher:  $\pm 30$  mm

Without extinguisher:  $\pm 100$  mm

### ▲ WARNING

The extinguishing area is approx. 60 cm in diameter, when the installation height is in accordance with the table. The installation height has an effect on the size of the extinguishing area and the extinguishing capacity.

### 🚩 ATTENTION

The Central Unit ① is plugged into the wall socket with its own power supply ②.

## 2. Installation - Optional

Install the extinguishing unit (E)

### ▲ WARNING

Read user manual before installing or replacing the extinguishing unit.

Service and replacement of the extinguishing unit (E) may only be done by service authorized by Safera.

Make sure that the hose is not squeezed after the installation. Minimum radius for the hose is 50 mm.

Highest allowed operation temperature for extinguishing unit (E) is 50°C.

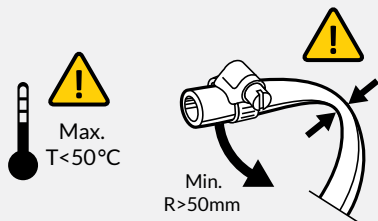

Install extinguishing unit (E) on top of the cooker hood according to the figures below (either A or B) and steps 1-9 on the figures on the right.

### Option A

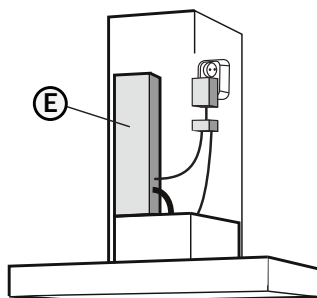

### Option B

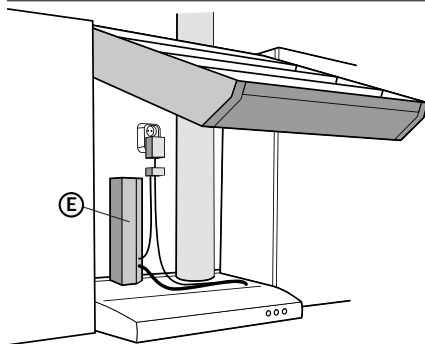

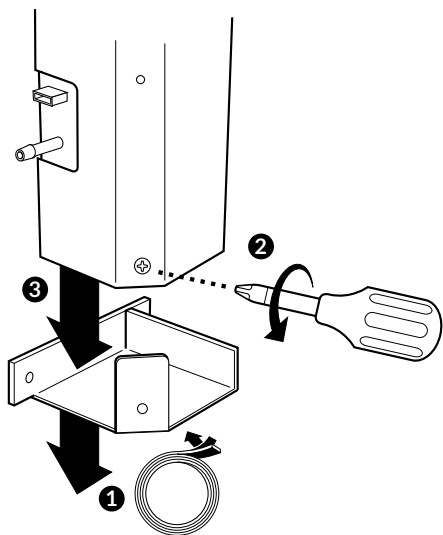

### ▲ WARNING

Ensure that the extinguisher unit is connected to the connection hub (F) and power supply (D).

### 🔍 HINT

With some of the cooker hood models the extinguishing unit (E) is pre-installed in the factory: in that case ensure that the hose and the cable are properly connected.

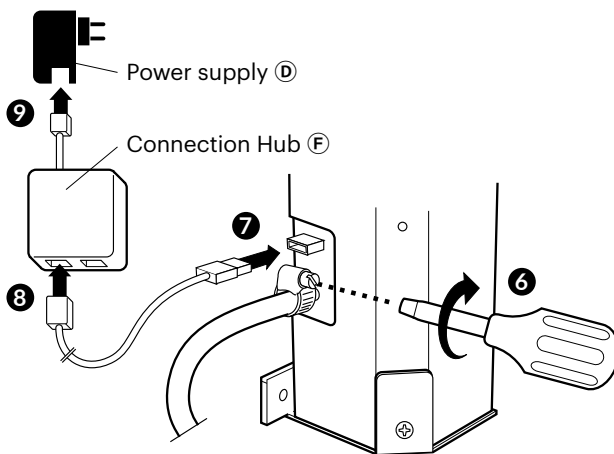
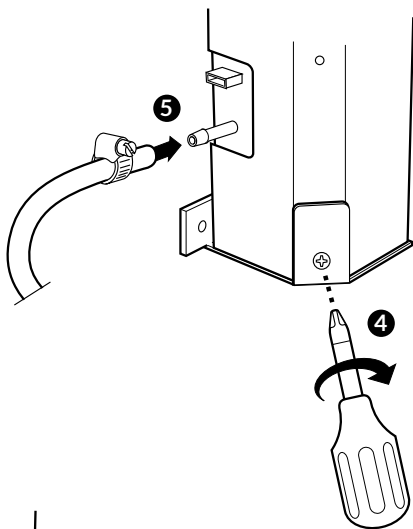

## 2. Installation - Step 2/6

Mount the Power Control Unit ©

Install the Power Control Unit according to the following instructions.

### PCU6.3-F

Fixed 3-phase connection.  
See pages 10-11.



### PCU6.3-P

Perilex-connectors.  
See pages 12-13.



### PCU6.1-F

Fixed 1-phase connection.  
See pages 14-15.





## PCU6.1-P

1-phase, 3-pin plug OUT.  
See pages 16-17.



## PCU6.1-S

Schuko-connectors.  
See pages 18-19.



## PCU6.3-F - Installation

Fixed 3-phase connection.

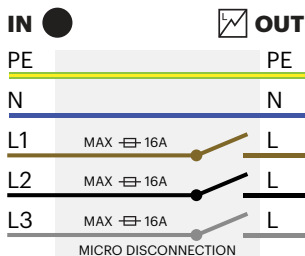
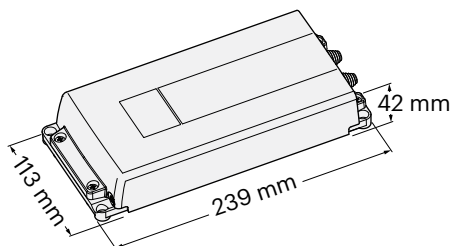
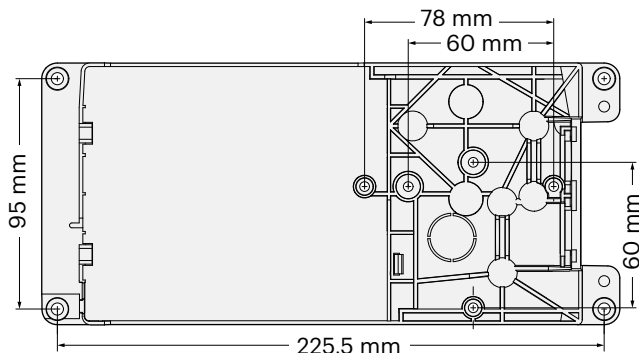

### ▲ WARNING

Make sure that there is no power supply to the cooker and the oven by removing their fuses. Also ensure that the cooker is switched off.

OUT-wires are always energized when the power control unit is connected to the mains power. If a wire is loose, it must be properly covered.

Do not install the power control unit where it will be exposed to excessive heat: See operational ambient temperature on the power control unit ③.

### ⚠ ATTENTION

Install the power control unit ③ so that it is not exposed to moisture. Check that all cables can move freely.

If you are replacing a cooker, press the adjustment mode button ⑦ for five seconds until you hear a signal. Continue the installation according to step 3/6 point 3.

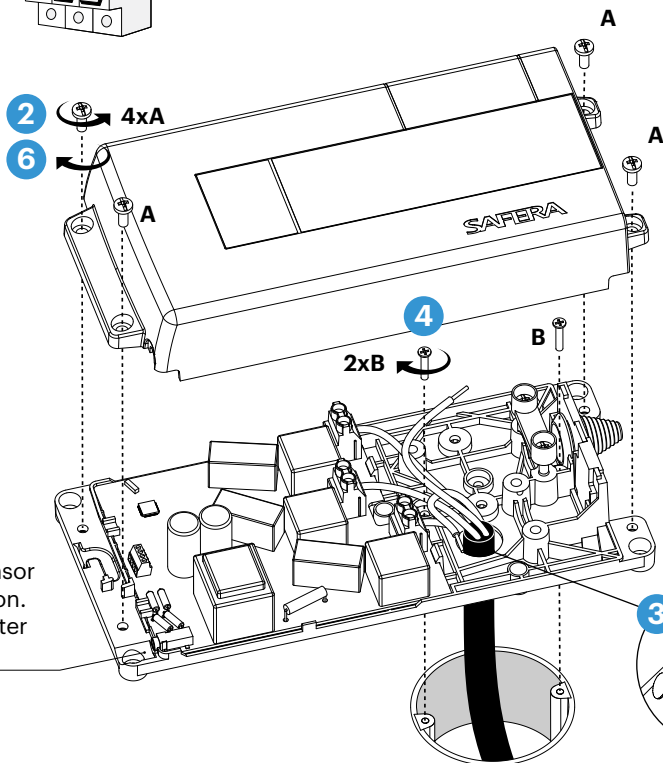
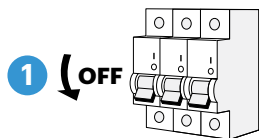

Optional  
water sensor  
connection.  
See chapter  
4.

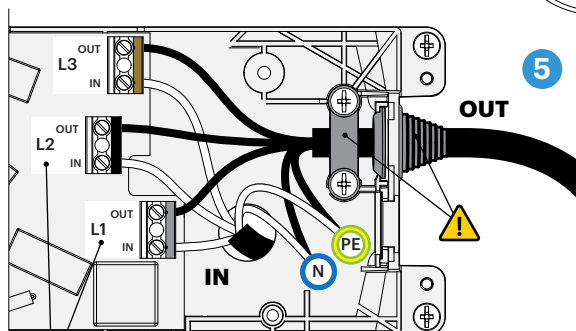

Phase order can be freely chosen. If only two phases are used, connect them to the terminals L1 and L2.

**7** Don't reconnect the power to the cooker yet.

## PCU6.3-P - Installation

3-phase, Perilex-connectors.

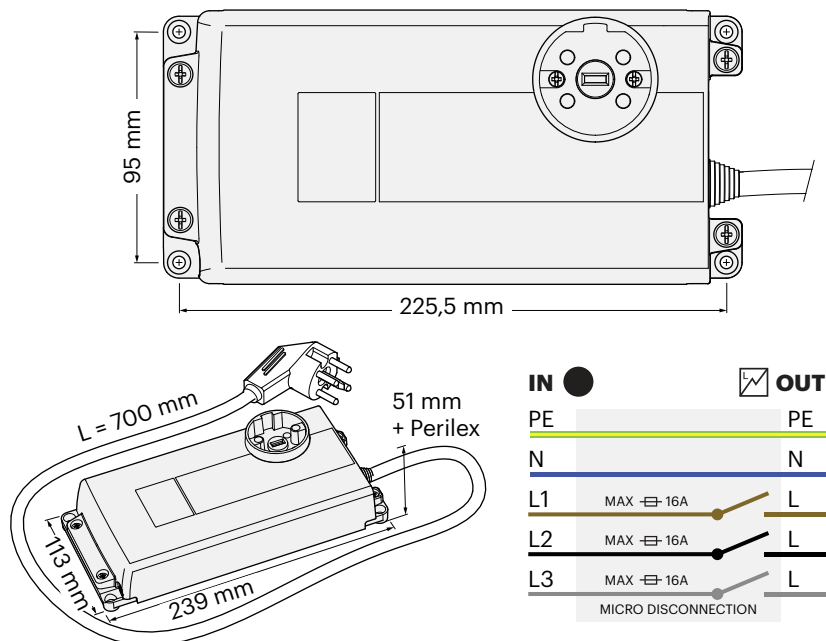

### ▲ WARNING

Make sure that there is no power supply to the cooker and the oven by removing their fuses. Also ensure that the cooker is switched off.

OUT-wires are always energized when the power control unit is connected to the mains power. If a wire is loose, it must be properly covered.

Do not install the power control unit where it will be exposed to excessive heat: See operational ambient temperature on the power control unit ③.

### ⚠ ATTENTION

Install the power control unit ③ so that it is not exposed to moisture. Check that all cables can move freely.

If you are replacing a cooker, press the adjustment mode button ⑦ for five seconds until you hear a signal. Continue the installation according to step 3/6 point 3.

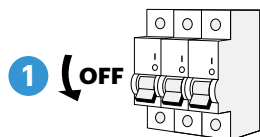

- 2** Mount the power control unit © on the wall behind the cooker or into the cabinet next to the cooker.

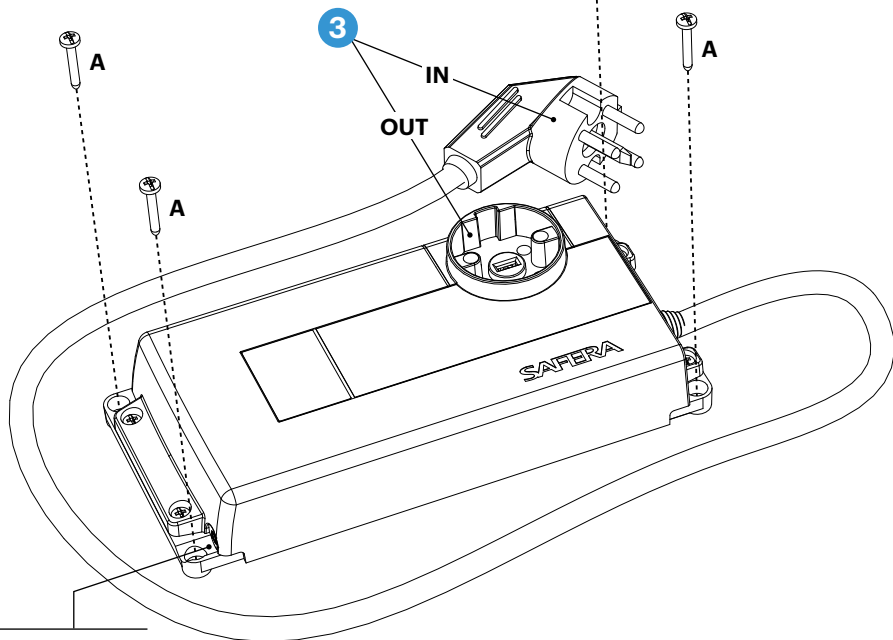
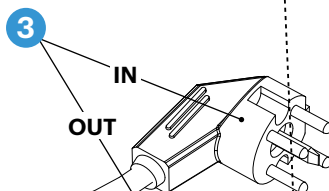

Optional  
water sensor  
connection.  
See chapter 4.

- 4** Don't reconnect the power to the cooker yet.

## PCU6.1-F - Installation

Fixed 1-phase connection.

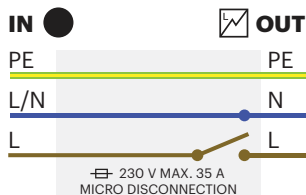
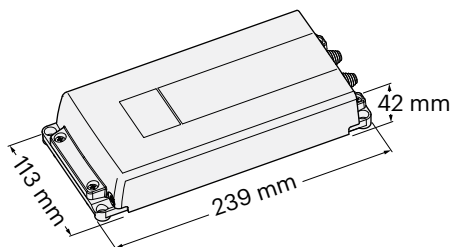
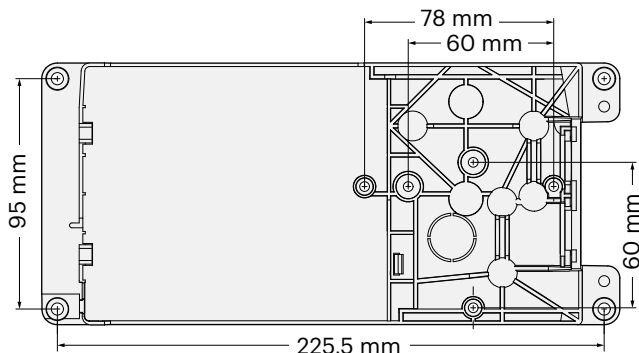

### ▲ WARNING

Make sure that there is no power supply to the cooker and the oven by removing their fuses. Also ensure that the cooker is switched off.

OUT-wires are always energized when the power control unit is connected to the mains power. If a wire is loose, it must be properly covered.

Do not install the power control unit where it will be exposed to excessive heat: See operational ambient temperature on the power control unit ③.

### ⚠ ATTENTION

Install the power control unit ③ so that it is not exposed to moisture. Check that all cables can move freely.

If you are replacing a cooker, press the adjustment mode button ⑦ for five seconds until you hear a signal. Continue the installation according to step 3/6 point 3.

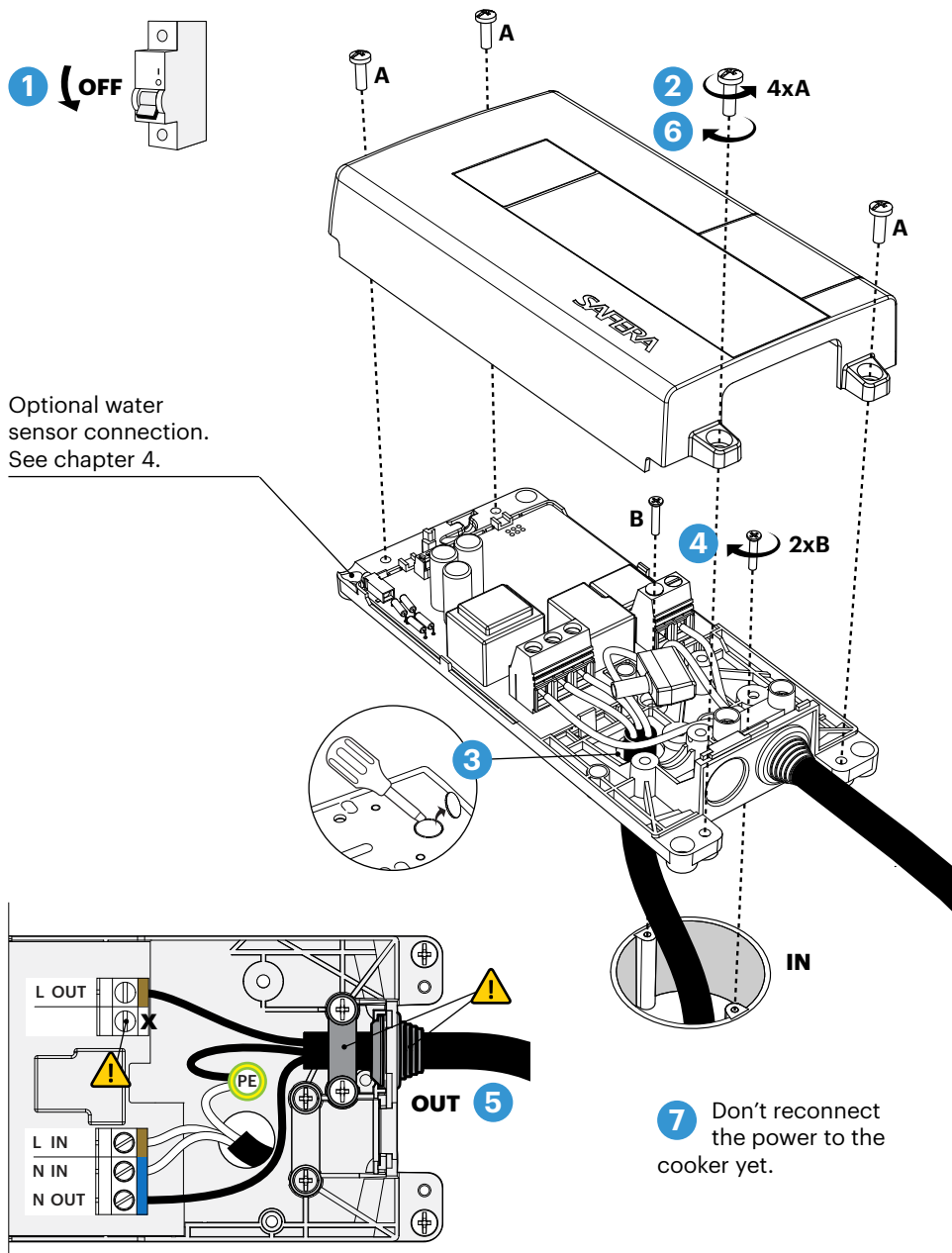

## PCU6.1-P - Installation

1-phase, 3-pin plug.

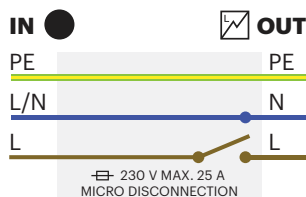
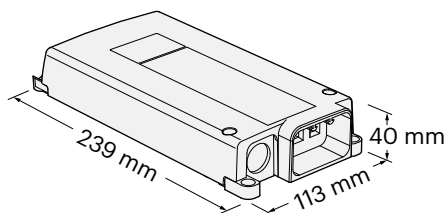
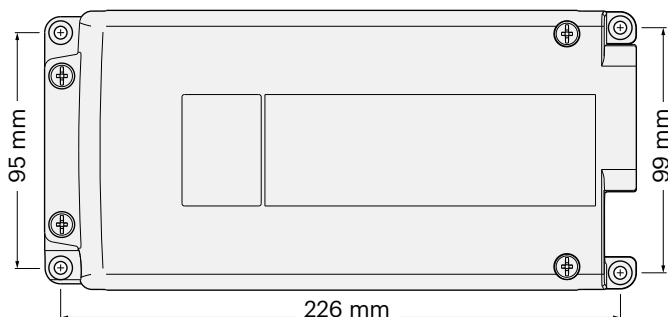

### ▲ WARNING

Make sure that there is no power supply to the cooker and the oven by removing their fuses. Also ensure that the cooker is switched off.

OUT-wires are always energized when the power control unit is connected to the mains power. If a wire is loose, it must be properly covered.

Do not install the power control unit where it will be exposed to excessive heat: See operational ambient temperature on the power control unit ③.

### ⚠ ATTENTION

Install the power control unit ③ so that it is not exposed to moisture. Check that all cables can move freely.

If you are replacing a cooker, press the adjustment mode button ⑦ for five seconds until you hear a signal. Continue the installation according to step 3/6 point 3.



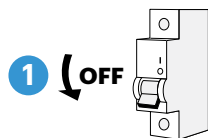

Optional water sensor connection.  
See chapter 4.

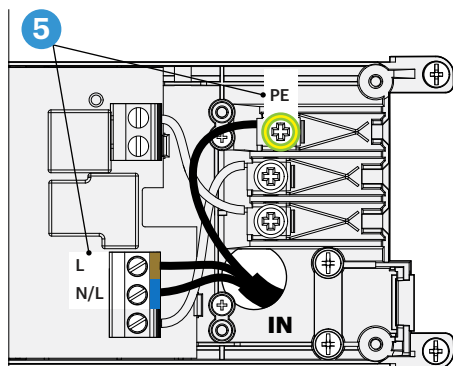
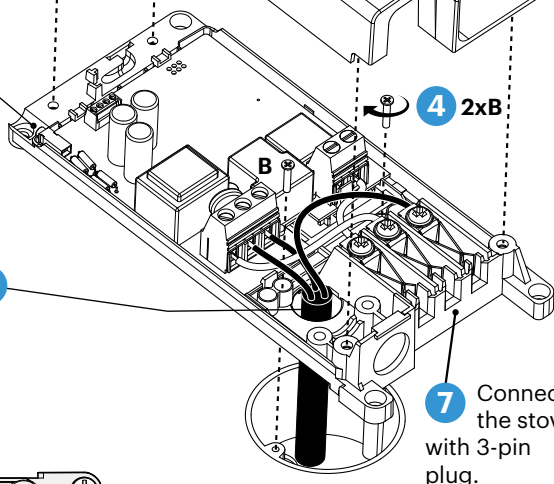
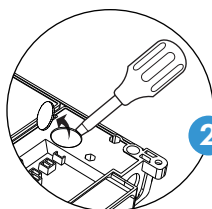
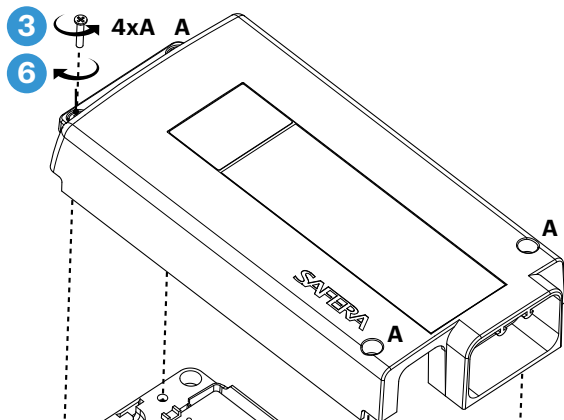

**8** Don't reconnect the power to the cooker yet.

## PCU6.1-S - Installation

1-phase, Schuko-connectors.

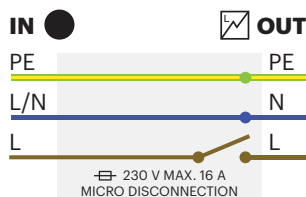
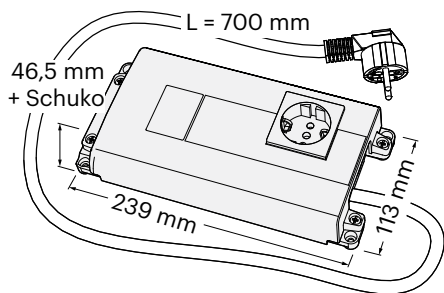
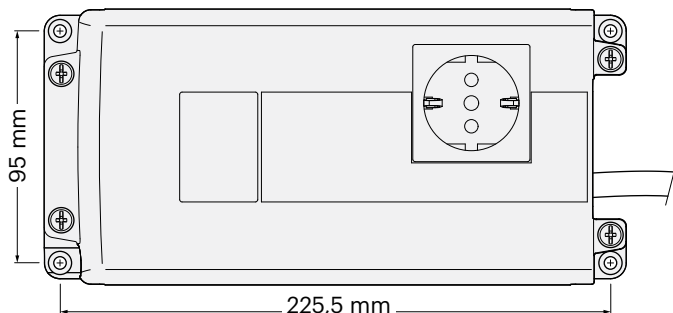

### ▲ WARNING

Make sure that there is no power supply to the cooker and the oven by removing their fuses. Also ensure that the cooker is switched off.

OUT-wires are always energized when the power control unit is connected to the mains power. If a wire is loose, it must be properly covered.

Do not install the power control unit where it will be exposed to excessive heat: See operational ambient temperature on the power control unit ③.

### ⚠ ATTENTION

Install the power control unit ③ so that it is not exposed to moisture. Check that all cables can move freely.

If you are replacing a cooker, press the adjustment mode button ⑦ for five seconds until you hear a signal. Continue the installation according to step 3/6 point 3.

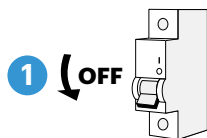

- 2** Mount the power control unit © on the wall behind the cooker or into the cabinet next to the cooker.
- 4x A

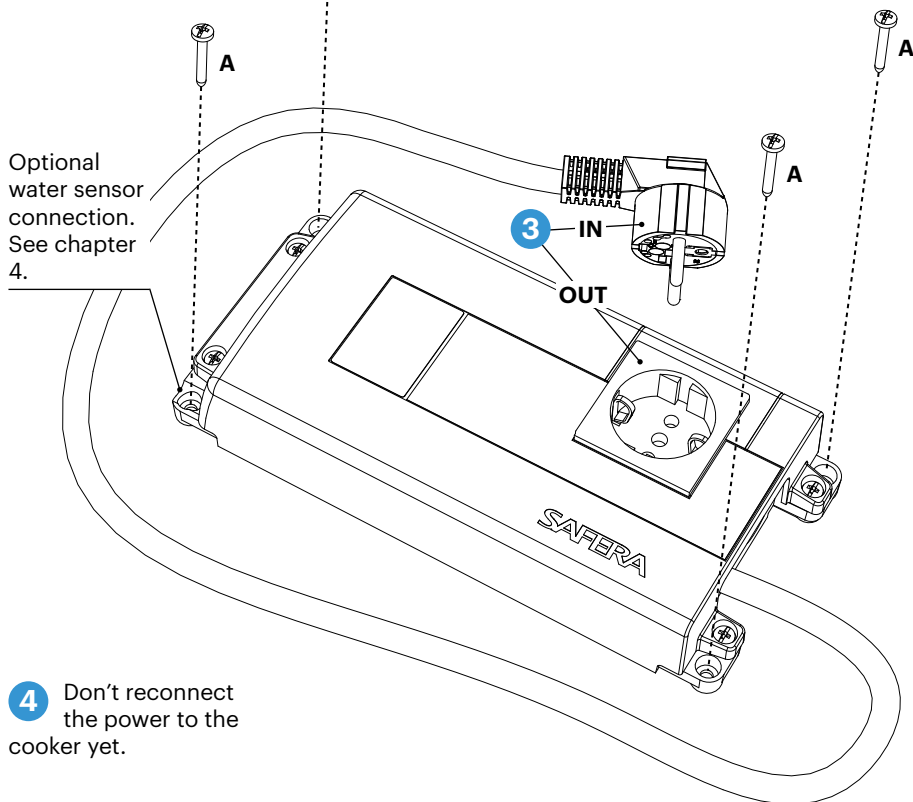

- 4** Don't reconnect the power to the cooker yet.

## 2. Installation - Step 3/6

Set up the wireless connection

- 1 Connect the power supply ⑩ to the Sensor unit ①: indicator light panels ③ are lit in purple.

**Without extinguisher unit ⑤:**

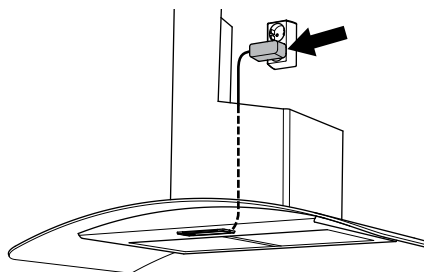

**With optional extinguisher unit ⑤:**

Ensure that the connection hub ⑥ is connected between sensor unit ① and power supply ⑩.

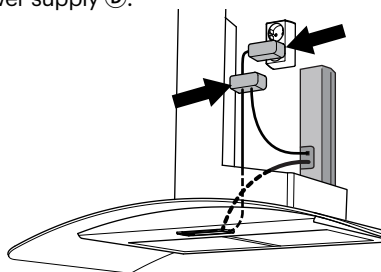

- 2 Press the adjustment mode button ⑦: indicator light panels ③ start blinking purple.

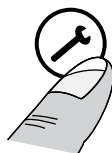

- 3 Put back the fuses for the cooker and the oven. The Power Control Unit ④ will now contact the Sensor unit ① which gives a sound signal (•••).

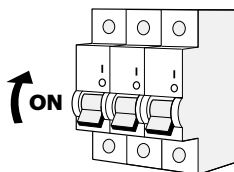

### HINT

You can re-start the installation process from step 3/6 point 3 anytime by pressing the adjustment mode button ⑦ for five seconds until you hear the signal.

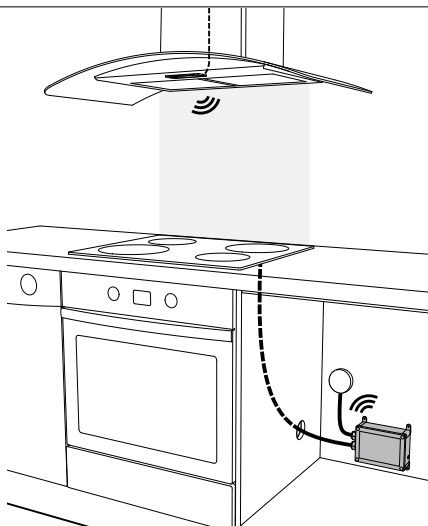

## 2. Installation - Step 4/6

Calibrate the system

- 1 When the indicator light panels 3 start blinking yellow-green, you need to calibrate the system. Choose from the two options:

### Option 1:

Cooker **and** oven are connected to the Power Control Unit ③.

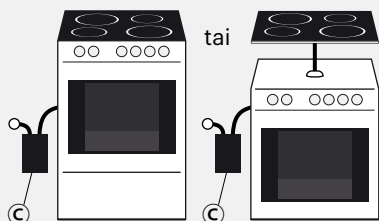

Turn on the oven and press the child proof lock button 1. When you hear a sound signal, turn off the oven.



or

### Option 2:

**Only** cooktop is connected to the Power Control Unit ③.

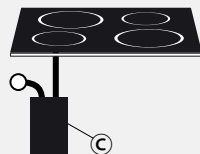

Turn on the biggest cooker plate with maximum power and press the OK-button 2. When you hear a sound signal, turn off the cooker.



#### HINT

With induction cooker, use a compatible dish.

- 2 Check that the indicator light for normal activity 4 blinks every five seconds.

## 2. Installation - Step 5/6



Adjust the alarm limit

**1** Check the closest recommended alarm limit from the reference table on the right.

**The range is 1-12:**

1 = reacts fastest

12 = reacts slowest

| Location of the Cooker  | Installation Height | Alarm Limit (1-12) |
|---|---------------------|--------------------|
| In a corner<br>    | 75 cm               | 6*                 |
|   | 65 cm               | 7                  |
|   | 55 cm               | 8                  |
|   | 45 cm               | 9                  |
| Next to a wall<br> | 75 cm               | 5                  |
|   | 65 cm               | 6*                 |
|   | 55 cm               | 7                  |
|   | 45 cm               | 8                  |
| In an island<br>   | 75 cm               | 4                  |
|   | 65 cm               | 5                  |
|   | 55 cm               | 6*                 |
|   | 45 cm               | 7                  |

\* Default

**2** Adjust the alarm limit according to the reference table above. The default alarm limit is 6.

**First, go to the adjustment mode:**

Press the adjustment mode button **7**: indicator light panels **8** lit white.



**Then, adjust the alarm limit:**

12  
11  
10  
9  
8  
7  
6 = default  
5  
4  
3  
2  
1

Raise the alarm limit (+1): press the OK-button **2**.



**6 = default**

Lower the alarm limit (-1): press the lock button **1**.



**3** When you adjust the alarm limit, the new alarm limit is indicated as shown in the table on the right.

**HINT**

You may check the alarm limit by pressing the adjustment mode button **7** twice.

| Color of the indicator light panels ③ | Number of beeps | Alarm Limit |
|---------------------------------------|-----------------|-------------|
| Red                                   | ... ...         | 12          |
|                                       | ... ..          | 11          |
|                                       | ... .           | 10          |
|                                       | ...             | 9           |
|                                       | ..              | 8           |
|                                       | .               | 7           |
| Blue                                  | ... ...         | 6 (default) |
|                                       | ... ..          | 5           |
|                                       | ... .           | 4           |
|                                       | ...             | 3           |
|                                       | ..              | 2           |
|                                       | .               | 1           |

**⚠ WARNING**

Do not set the alarm limit higher than 9 during the installation.

If the alarm limit is set too high, the appliance may fail to detect a hazardous situation in time.

Check the working order of the appliance and fill in the installation checklist:

- ☐ All the burners of the cooker cause a child proof lock alarm.
- ☐ The oven (if connected) causes the child proof lock alarm. The sound signal is lower than the signal from the cooker child proof lock.
- ☐ The child proof lock turns off the oven and all the burners.
- ☐ The indicator light panels **8** are not lit red after installation.
- ☐ The alarm limit is set according to the cooker location.
- ☐ With optional extinguisher unit **E**: Ensure that the connection hub **F** is connected between sensor unit **A** and power supply **D** by pressing OK-button: the stove guard should beep once and the light panels **8** blink green three times.

\_\_\_\_\_  
Installation date

\_\_\_\_\_  
Installation place

\_\_\_\_\_  
Installer



### 3. Installation troubleshooting

| Problem   | Remedy  |
|---|---|
| Installation is not proceeding as expected.   | You can re-start the installation process anytime by pressing the adjustment mode button ⑦ for five seconds until you hear the signal and continue from step 3/6. |
| The sensor unit ① is not responding to any button and none of the indicator lights are lit.   | Ensure that the power supply ④ is connected correctly to the wall socket and that the socket has power.   |
| None of the cooker plates cause a child proof lock alarm.                                     | The wireless connection has not been properly made: redo the installation starting from step 3/6.   |
| The appliance turns off the power from the cooker, but the power comes back on immediately.   | Make sure that the Power Control Unit ③ is connected correctly – in other words, the cooker is connected to the OUT cable.  |
| If the light panels ⑧ are constantly lit red after the installation, the appliance is faulty. | See user manual chapter 5. Troubleshooting.   |

## 4. Installing the Water Leakage Sensor (optional)

Stove Guard can be equipped with max. four Safera Water Leakage Sensors. The sensors are placed in the typical leakage areas, e.g. under the dishwasher or sink.

- 1 Attach the sensors **F** in place.
- 2 Attach the plug **G** of the leakage sensor to the Power Control Unit **H**.
- 3 If there is an extra sensor, its plug **G** is connected to the connector **I** of the previous sensor.
- 4 Check the operation of the furthest sensor **F** by placing a damp paper towel against it for 15 seconds. When the water is detected, the Sensor unit **A** gives a sound signal, the warning light for water leakage **B** blinks and light panels **B** blink blue.
- 5 Reset the leakage alarm by pressing the OK button **2**. Clean and dry the sensor.

### HINT

If the sensor is left wet, the appliance will give another alarm in an hour after signing off the previous one.

